



R-25

Specifications

Engine: Yamaha F250 outboard engine

LOA (motor down): 28' 5" | 8.66 m

LOA (motor up): 29' 8" | 9.04 m

Draft (motor down): 34" | 0.86 m

Draft (motor up): 19" | 0.48 m

Beam: 8' 6" | 2.59 m

Bridge clearance (mast down, w/ radar): 8' 6" | 2.59 m

Height on factory railer (mast down, w/ radar, est.): 11' 10" | 3.61 m

Height on factory trailer (mast down, w/o radar, est.): 11' 2" | 3.4 m

Length on factory trailer (motor down, est.): 34' 6" | 10.52 m

Length on factory trailer (motor up, est.): 36' | 10.97 m

Fuel capacity: 99 US gal | 374.8 L

Water capacity: 34 US gal | 128.7 L

Waste capacity: 14 US gal | 53 L

Weight, dry: 6,500 lbs | 2,949 kg

The R-25 is a feature-packed cruiser designed for comfort, ease of use, and FUN! You'll find the Ranger Tugs DNA built into every facet of the R-25's thoughtful design.

Right away you'll notice one of the most innovative features of the R-25, our Clear-Path swim platform.

The extended swim platform wraps around the outboard to present a clear walkway free of all engine rigging, which opens a whole new world of fishing, cruising, and water-sports opportunities. This exciting new design features heavy duty handrails and allows you to safely and easily board a dinghy, net a fish, step to or from a low dock (important for pets), and med-tie without fear of damaging your outboard and having to leap to the dock.

The main salon on the R-25 is light and bright, making it a perfect spot to relax or entertain. The dinette seats four or converts to a bed for two. The forward stateroom is private and comfortable featuring a large bed, opening hatches for airflow, reading lights, and a TV. The R-25 features a fully enclosed head equipped with an electric marine toilet, sink and shower. There's even a spacious quarter berth with a removable mattress that can be used to accommodate guests/kids or for expanded storage. An electric/alcohol stove top, refrigerator/freezer combo, microwave, and sink with hot and cold water, make food prep fun and easy.

The easily trailerable Ranger Tugs R-25 is a fantastic boat for cruising, fishing, and fun on the water. The private head, extended swim platform, multiple sleeping areas, and full galley give you everything you need to get away from the dock and spend some serious quality time with (or without) your friends and family.

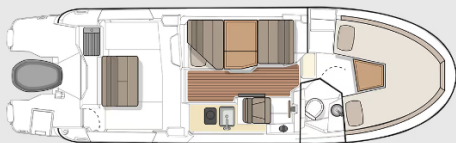

Model Features

Clear Path Swim Platform

A revolution in usability and safety, this new area features 20 sq ft. of non-skid decking for fishing, swimming, deck or dinghy access and more.

Laminar Flow Interrupters

The R-25 is equipped with our Laminar Flow Interrupters for smooth, positive cornering performance.

Full Galley

An electric/alcohol stove top, refrigerator/freezer, microwave, hot and cold galley sink, cutting board, and ample storage & counter space makes food prep a breeze.

Multi-use Seating

The aft bulkhead window opens, and the dinette seat transforms to create a rear facing seat. Combined with the Lounge, the R-25 boasts cockpit seating for 5 adults.

12" Garmin Chartplotter

Navigation is fun and accurate with a 12" Garmin Chartplotter with sonar. Easily monitor fuel flow, engine data, bottom conditions, GPS location, tides and much more.

Solar Panel

The included solar panel helps to keep your batteries charged while you're boating off-grid. Now you can go further and stay longer without the need for shore power or a generator.

Performance

250 HP Yamaha F250 outboard,
electric steering (DES)
Electric trim tabs
Laminar flow interrupters
Bow thruster
Trailable - 8' 6" beam

Accommodations & Interior

Comfort

Climate control (heat and air conditioning)
Aftview skylights
Cabin drink holders, 5
Curtains for privacy
Dinette (seats 4) converts to bed
Fully enclosed head
Hatches, pilothouse roof, solar reflective, 4
Hatches, stateroom, 2
Indirect cabin lighting
Kicker stereo system (multi-zone)
LED lighting
Electric marine toilet w/ holding tank, pump out
Midship berth
Opening portlights, 2
Private forward stateroom
Shower with enclosure
Storage under mattress
TV in stateroom

Deck Features

Anchor package, 16.5 lb, 50' chain, 150' line
Clear Path engine rigging
Clear Path swim step
Folding stainless steel mast for trailering
Forward line storage
Rod holders, 3
Sport racks, stainless steel
Swimming ladder, stainless steel
Swim step, with built-in fenders
Washdown system
Windlass

Cockpit

Cockpit cover, roll-top
Cockpit seating, 5+
Downrigger plugs and pads
Opening glass bulkhead w/ reversible seat
Transom entry door for boarding

Helm

Color engine display
Digital fuel flow data
Electronic shift and throttle control, single-lever
12" Garmin navigation system w/ GPS and sonar
Helm drink holders, 2
Helm seat, bolstered
USB charging ports
Windshield wipers, 2

Galley

Cutting board
Galley cabinets, 2
Galley drawers, 1
Microwave
Pull-out rinse faucet
Refrigerator/freezer
Sink with hot and cold water, with pull-out rinse faucet
Stove top, electric/alcohol

Mechanical & Electrical

AC electrical panel
Batteries
Battery charger
DC electrical panel
Galvanic isolator
Inverter
Lithium (LiFePO4) house batteries
Macerator discharge
Smart Plug Inlet and 30amp
Shorepower Cord
Solar panel, 175w with controller
Underwater lights

Safety

Carbon monoxide detectors
Courtesy lights
Electric horn
Illuminated compass
Integrated trailer lights
Navigation lights
Safety kit: fenders, lines, fares, fire ext, first aid kit, life jacket, boat hook
Swim platform rails
VHF radio, DSC capable
Window defrosters

Construction

Bonded electrical system
Foam-filled fiberglass stringer grid system
Premium hull color, Midnight Blue
Seawater shrouns(s)
Self-bailing cockpit
Stainless steel cleats, rails, hardware
Vinylester barrier coat

Options (visit Build-A-Boat for current pricing)

Aft cockpit sun shade with sunset shade

Garmin xHD radar

Autopilot with remote

Electric Grill

Auxiliary motor bracket

Auxiliary Motor Package: 9.9, electric steering with wireless remote

Factory Delivery Experience

Hull color upgrade

Dinghy Lift w/ 260 RIB inflatable

Aluminum tandem axle trailer with electric/hydraulic brakes spare tire/bracket

Options, freight & taxes extra. Prices, specifications, equipment, and options may change without notice. Information on this sheet should not be used for navigation.

July 30, 2025

